

## Phase Wall Sconce Installation Instructions

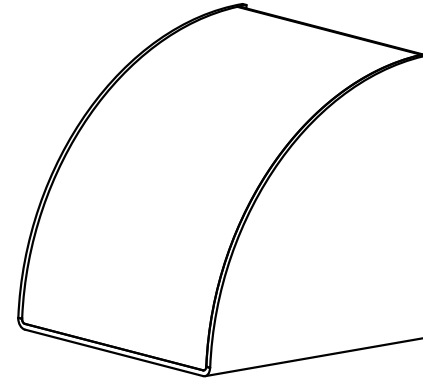

# Resident

## Phase Wall Sconce Installation Instructions

Product Code: PHA04



Warning, installation must be completed by a certified Electrician only.

### Assembly Kit Contents:

- 1 x Wago connector 3 pole
- 1 x 24V Driver
- 4 x Wood Screws

This wall sconce is an LED luminaire, which requires an external driver to provide a 24V electricity source. The driver included in your purchase is Triac (Phasecut) dimmable. Other types of dimmable drivers are available for individual sale.

**1** If this light is being installed in the USA the driver will need be to be placed in a UL registered enclosure. To install the light follow the instructions below:

- Create a cavity in the wall to accommodate the driver. Ensure the cavity does not exceed the dimensions of 60mm (2.4 inches ) by 60mm (2.4 inches). This cavity should be aligned centrally with the ceiling bracket.
- If installing in the USA, cable entry should be in front of the UL registered enclosure. If required, this will need to be supplied by the installer.

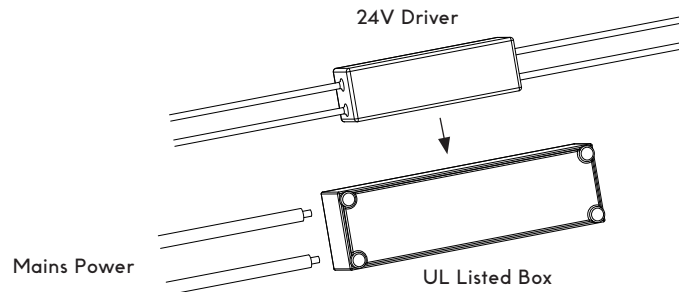

**2** Connect the Driver to mains power:

- Connect the line of incoming mains Live to power supply via the L pin on the input side of the driver.
- Connect the line of incoming mains Neutral to power supply via the N pin on the input side of the driver.

**3** Trim excess wire if required.

- Connect the pendant suspension cable (labelled '-') to the pin (labelled '-') on the output side of the driver.
- Connect the pendant suspension cable (labelled '+') to the pin (labelled '+') on the output side of the driver.

**4** Secure the bracket over the wall cavity using the provided wood screws. If mounting on concrete or brick, the installer should provide their own screws.

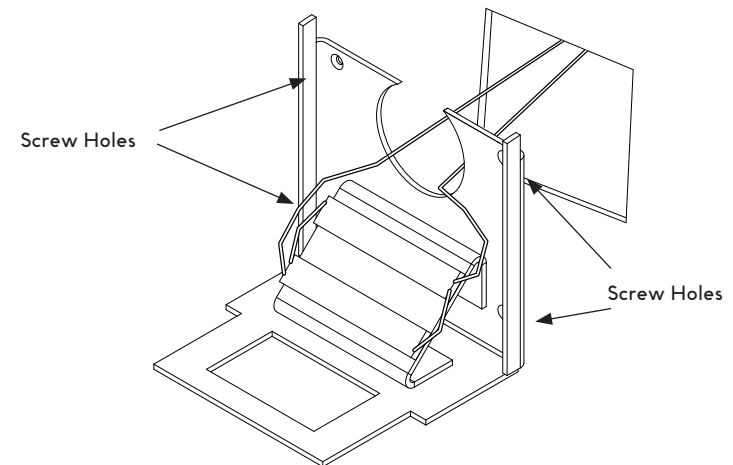

- 5 Position the folded body onto the bracket, ensuring it is flush with the wall.
- The two parts are aligned when the magnet attached to the folded body slots into the hole in the bracket.

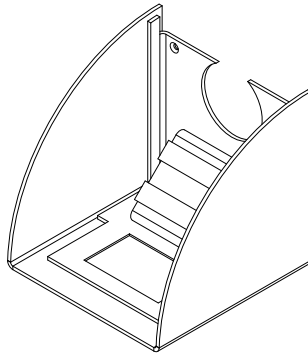

- 6 Slide the diffuser vertically onto the bracket. The magnets will align with each other, holding the wall sconce together.

Your wall sconce is now installed.

